

“ADM “ - “ADM NTX“ - Automatic Decapping Machine

- QUICK INSTRUCTIONS -

***Complete Operating * CE - USER MANUAL, must be downloaded in download area from : www.shooting-tech.com , or ask it to the seller**

All information in this publication is based on the latest product information available at the time of approval for printing. Technique Engineering (T.E.) reserves the rights to make changes at any time without notice and without incurring any obligation. Illustrations in this manual are used to show the basic principles of operation and work procedures. They may not represent the actual product exactly in exact detail. No part of this publication may be reproduced without written permission.

USE DESTINATION

The **ADM** (Automatic Decapping Machine) and **ADM NTX** are devices to remove the used primers from metal cartridge cases that have primer site type Boxer, a necessary operation to reuse the cartridge case for the production of firearms ammunition .

EQUIPMENT

The machine ADM It is supplied with the components listed below:

- N.1 Machine
- N.1 Electric transformer with cable
- N.1 9x19 – 9x21 case Feed pipe
- N.8 9x19 – 9x21 bushings
- N.1 Quick Instruction / *CE user manual



THE **ADM NTX** DIFFERS FROM THE **ADM** MACHINE FOR THE MORE POWERFUL ELECTRIC GEARMOTOR IN ORDER TO DECAPSULATE EVEN NON-TOX CARTRIDGE CASES WITH THE SAME 1.7 mm DECAPPING PIN, AND FOR THE DIFFERENT SPEED. THEIR ELECTRONIC BOARDS ARE DIFFERENT FOR THE SOFTWARE AND THEY ARE NOT INTERCHANGEABLE

ASSEMBLY

Remove the protective material of the packaging , assemble the plate supports , screwing them to the bottom of the machine. Insert in the drum the case centering bushings . For each caliber there are the corresponding bushings. Fasten the cartridge cases feed tube to the machine with a 4mm Allen key, with the flared part facing upwards (cases entry from the dispenser).



Remove the machine from packaging

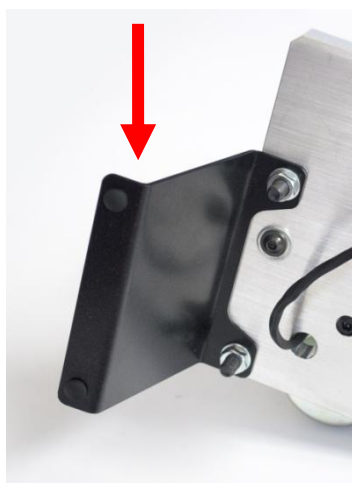

Support Fixing



Shells feed tube Fixing



Insert in the drum the case centering bushings



IN CASE OF RETURN WITH SHIPMENT, TO AVOID EXTRA COST DUE TO DAMAGE DURING THE TRASPORT, YOU MUST STORE AND USE THE ORIGINAL PACKAGE AS RECEIVED.



Feed tube assembly: to connect to an electric cases feeder (not included). CHECK THAT THE PIPE IS IN AXIS WITH THE BUSHING HOLE

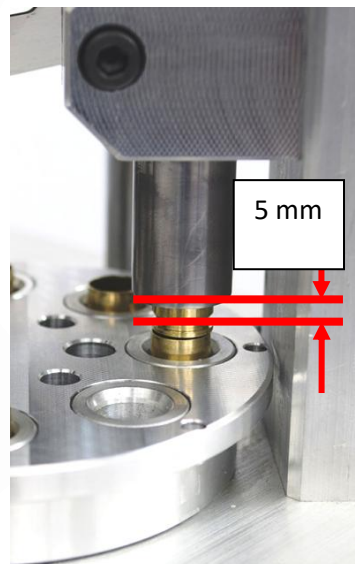

Connect transformer to electric power

Connect the cable of the ADM machine to the electric transformer

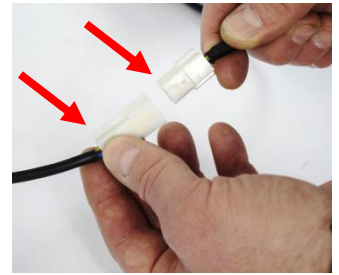

OPERATING

Press "ON" in the switch transformer

For 5 seconds the display will show as follows:

S-tEeH

Then the display will be as follows:

S-tOP

Push **START** button and make a no-load operation test. The machine must operate without noise.

If it's all OK push **STOP**. The ADM machine is ready to work, complete the connection of the case feed pipe with the case feeder.

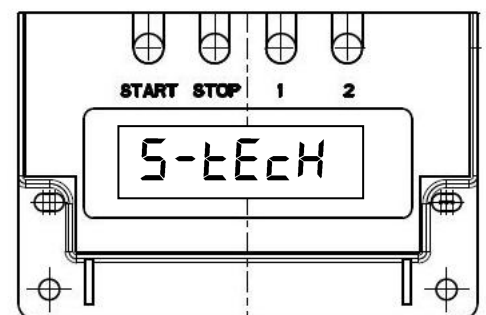

"ADM" Drive Unit

Press the "START" button to run the machine at "SPEED 1" (approx. 2,000 cases per hour).

To increase the speed: if the Decapping Machine is working, press STOP and after press button 1 to increase the speed, the button 2 to decrease the speed. When you press the button 1 or 2 you can see the SPEED 1 or 2 or 3 in the display.

After selecting the speed, press Start and the ADM will operate according to the chosen speed

SPEED 1 ----->2.000 cases per hour ---- NTX 2.150 cases per hour

SPEED 2 ----->2.400 cases per hour ---- NTX 2.550 cases per hour

SPEED 3 ----->2.800 cases per hour ---- NTX 3.000 cases per hour (SPEED not for Rifle Cartridge Cases)

To stop the machine : push the STOP button .

Manual drive : press STOP for 4 second in "MANUAL" and then push "1" or "2" button to run counter clock or clock wise engine rotation

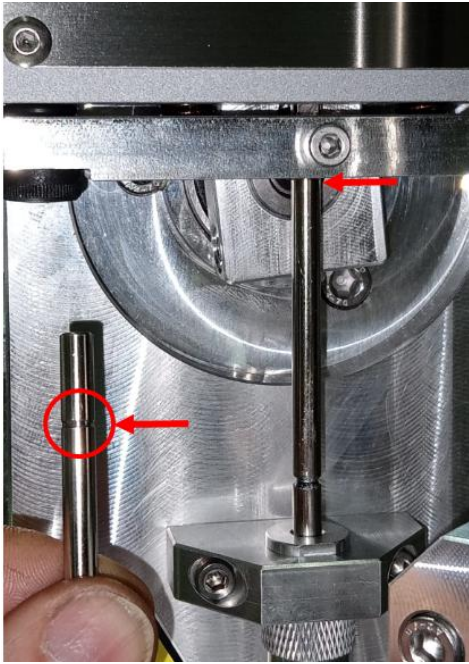
COMPOUND ROD OR PIN REPLACEMENT

For compound rod replacement reassemble the rod by aligning the groove with the lower base of the rod holder plate then fix the screw
For pin replacement : be sure to fix well using the 5 mm key the punch head

Add loctite blue in thead to fix the Punch head to the ROD. If the head punch . **Unscrewing the punch head during operation and touching the bottom of the case, it will cause damage to the machine , Bearings and Plastic gear !**



For complete operating instructions, drive unit message ,general data, warnings, etc, refer to * CE User manual.

LAYOUT

"ADM" installation layout with a case feeder



Primers exhaust on the back

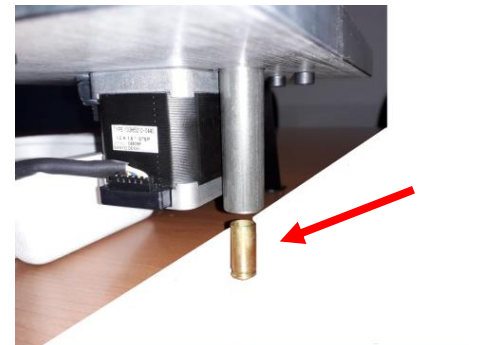

Shell exhaust in the front side; the brass must be free to fall down

PISTOL CALIBER KITS

It is possible to change and use the following caliber kits: below description and purchase codes

PISTOL CALIBER KITS

Replace the 9 mm bushings and feed pipe with dedicated ones :

	40 CALIBER KIT
DEC_050_	40Bushings kit 40 (No. 8 pcs)
DEC_081	FEED PIPE 40

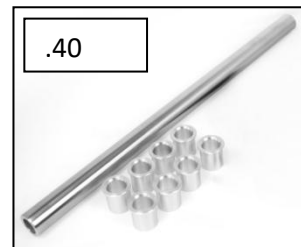

	.45 CALIBER KIT
DEC_050_45	Bushings kit 45 (No. 8 pcs)
DEC_052	FEED PIPE 45

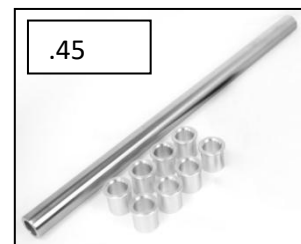

RIFLE CALIBER KITS

To decapping rifles brass, replace the protection punch bush unscrewing the standard 9 mm and screwing the new

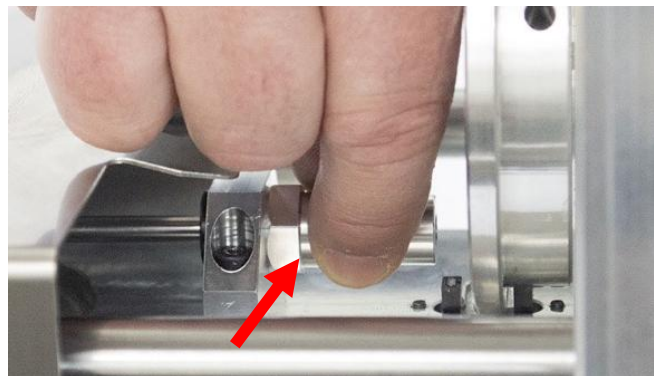

put on the top of the existing Aluminium Drum the additional plastic drum with the drive pins in the drum holes .



DEC_058_223	RIFLE KIT 223
DEC_051_223	PLASTIC DRUM PLUS PINS
DEC_053_223	PROTECTION PUNCH FOR 223

.223

DEC_058_308	RILFE KIT 058/308
DEC_051_308	PLASTIC DRUM PLUS PINS
DEC_050_45	45 BUSHING KIT
DEC_052	FEED PIPE cal. 45
DEC_053_308	PROTECTION PUNCH FOR .308



.308

DEC_058_38_357	REVOLVER KIT 38/357
DEC_051_38/357	PLASTIC DRUM PLUS PINS
DEC_050_40	40 BUSHING KIT
DEC_081	FEED PIPE cal. 40
DEC_053_38/357	PROTECTION PUNCH 38/357



.38/357



BEFORE USE : READ GENERAL WARNINGS in the COMPLETE USER MANUAL!